

Dale®

Post-Surgical Bra

Application Instructions

1. Detach straps and place the bra under the patient.
2. Grasp both sides of the bra and press together. There should be some tension.
3. Attach straps to front of bra at the top of the band.
4. Bra can easily be adjusted by peeling fasteners apart at front and straps.

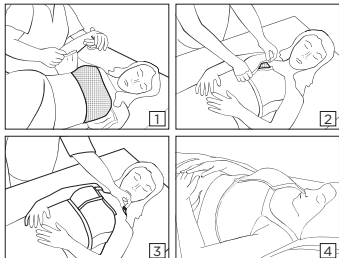

Alternative Application

The Dale Post Surgical Bra may also be applied without detaching the straps by gently guiding the patient's arms through the straps.

Laundering & Care



Machine wash warm.



Line Dry.



Do not bleach.



Do not iron.



Do not dry clean.

For single patient use. Disposable

For an application video please visit www.dalemed.com

Not made with natural rubber latex.

Dale® is a registered trademark of Dale Medical Products, Inc. in the USA & EU.

Dale Post-Surgical Bra

The Dale Post-Surgical Bra comfortably holds surgical dressings in place following most breast surgeries. Front hook & loop closure facilitates dressing changes and inspection of the surgical site.

Applications

The Dale bra can be used after a wide range of surgical procedures.

Key Features

- **Exclusive Comfort Fabric.**
Provides support and accommodates edema for duration of recovery.
- **Quick-fastening hook & loop front closure.**
Allows quick examination of the surgical site.
- **Convenient Sizing.**
Five sizes ensure full coverage and support for all.
- **Seamless Design.**
Minimizes skin irritation.
- **Not made with natural rubber latex.**



Dale Medical Products, Inc.
40 Kenwood Circle • Suite 7
Franklin, MA 02038-3298
T: +1-508-695-9316
www.dalemed.com



MDSS GmbH
Schiffgraben 41
D-30175 Hannover, Germany



Dale Medical Products, Inc.
40 Kenwood Circle • Suite 7
Franklin, MA 02038-3298
T: 508-695-9316



MDSS GmbH
Schiffgraben 41
D-30175 Hannover, Germany

